



Easy clean



4eBin™

Next generation in
bulk merchandising

Technical sheet

Treat shoppers to a transparent experience

Use bins to engage and attract



We listened to our customers.

Now HL bins are even easier to install and maintain!

Why HL bins are great:

- Product visibility stimulates impulse purchases
- First in, first out guaranteed
- Ergonomic pull handle provides a consumer friendly interaction.
- Easy to install using a cross-bar system or your existing shelving
- Save time assembly of the bin done in a few seconds
- Easy cleaning thanks to innovative design

UP TO **30%**
TIME SAVING
(compared to bins in the market)

* Source: HL internal test



New revolutionary easy-clean design

4eBin™ – The next generation in bulk merchandising

ECOLOGICAL – A more “eco-friendly” way of shopping. Less resources are used in both transport and packaging.

ECONOMICAL – Let’s shoppers buy their desired quantity, and favourite mix.

ERGONOMIC – A delight to handle for shoppers and store personnel alike.

EASY-CLEAN – Our revolutionary design allows for cleaning the bins without removing them from the shelf.



Just dry-wipe to clean inside of the bin body

Design features:

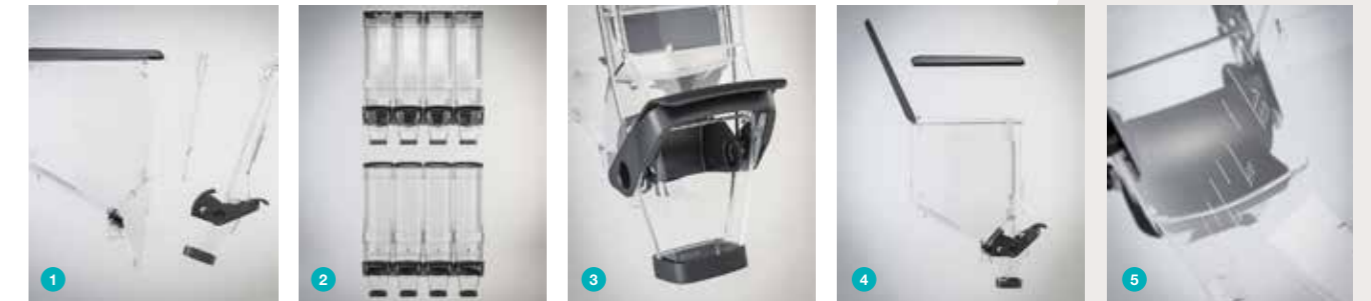

Bin body created in 1 part (1)	Easier mounting, dismounting and cleaning.	Smooth design of the nozzle (2)	More compact design
Ergonomic front cover	Easier mounting and dismounting	Ergonomic pull handle (3)	Provides a consumer friendly dispensing action.
False front*	Bins always look full and displays the content	Easy refilling (4)	Removable lid with open/close function and refilling position.
Dust proof lid	Designed to avoid dust/dirt traps.	Stock level (5)	Remaining stock can be read from side of bin.

* Optional feature to have a full face display even at low stock levels.



Scan to read more and watch product video!



4eBin™ - What is it and how does it work?

Gravity bins

STANDARD RANGE

- Available in 7.5, 12.5 and 20 litres.
- Hygienic closed system - consumers can see, but not touch the product unless buying.
- All models with or without false front depending on customer needs
- Standard flow control and ergonomic handle for optimal shopping experience and shrinkage reduction. First in - First out principle.
- Our gravity bins have been tested with positive results for product loads of 1:1 density, i.e. a 20L bin can sustain 20 kilos of merchandise.
- Transparent body - top lid, handle and sleeve is black as standard.
- US and European food contact certification. All bins are BPA-free.
- Label printing area 58x90 mm (for label holder width 100 mm). Label printing area 58x140 mm (for label holder width 150 mm)



BPA FREE

HL DISPLAY
2
years warranty



Our gravity bins are BPA/EA free and made in virtually unbreakable material approved for food contact.

Component overview

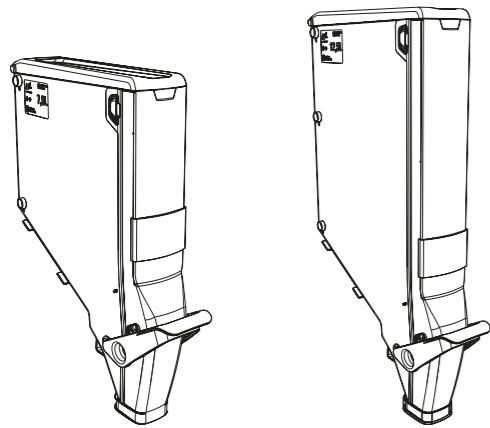
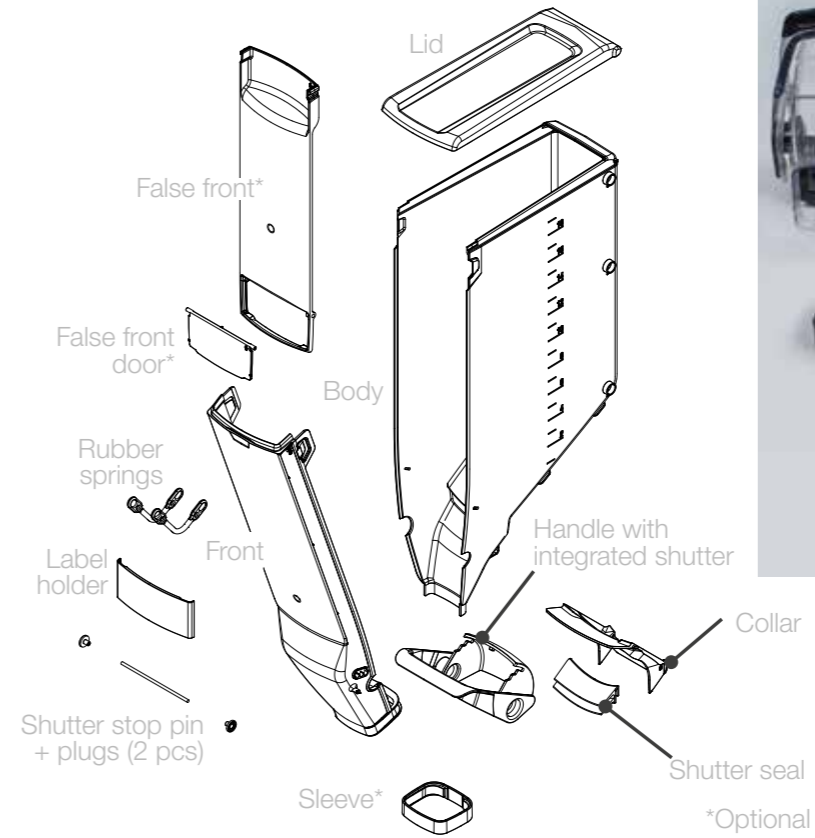

GB4e100-7,5

GB4e100-12,5

Model	False front included	Sleeve Included	Capacity (L)	Width mm	Height mm	Depth (mm)
GB4e100-7,5	NO	NO	7,5	100	525	370
GB4e100-12,5	NO	NO	12,5	100	675	370
GB4e100F-7,5	YES	NO	7,5	100	525	370
GB4e100F-12,5	YES	NO	12,5	100	675	370
GB4e100FS-7,5	YES	YES	7,5	100	525	370
GB4e100FS-12,5	YES	YES	12,5	100	675	370
GB4e100S-7,5	NO	YES	7,5	100	525	370
GB4e100S-12,5	NO	YES	12,5	100	675	370

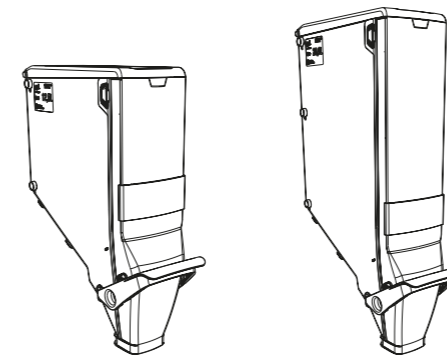

GB4e150-12,5

GB4e150A-20

Model	False front included	Sleeve Included	Capacity (L)	Width mm	Height mm	Depth (mm)
GB4e150-12,5	NO	NO	12,5	150	525	370
GB4e150-20	NO	NO	20	150	675	370
GB4e150F-12,5	YES	NO	12,5	150	525	370
GB4e150F-20	YES	NO	20	150	675	370
GB4e150FS-12,5	YES	YES	12,5	150	525	370
GB4e150FS-20	YES	YES	20	150	675	370
GB4e150S-12,5	NO	YES	12,5	150	525	370
GB4e150S-20	NO	YES	20	150	675	370



Installation

A bulk offering is an effective use of store space and creates differentiation. Introducing bulk bins is also an easy way of enlarging or adapting your offer to meet the needs of your local market demands.

Create destinations within your store where shoppers can engage fully with pick & mix of nuts, candies or cereals. Not only do bulk bins encourage greater interaction, they also give consumers more freedom to purchase the exact combination and quantity of the product they want.

All accessories in this page are compatible with 3eBin™



ON CROSSBAR WITH HOLDER:

- Remove shelves and install the crossbars at the desired height.
- Place the metal holder on the crossbar in the desired position.
- Hang the gravity bins onto the metal holder.

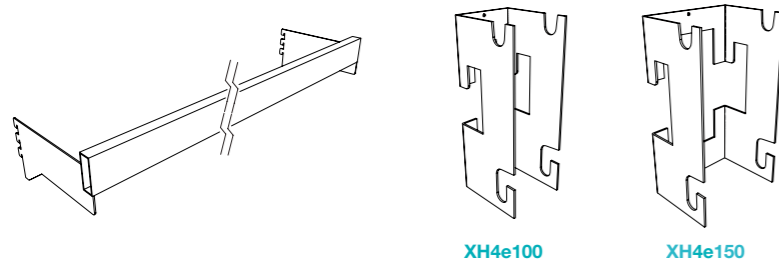

XH4e100

XH4e150



Installation on crossbars is the preferred option when whole section of bins are to be installed. The most durable!



4eBin can be installed in the existing XH holder as well as in the new XH4e holder.

ON CROSSBAR WITH SWING DOWN ARMS:

- Place the swing down arm on the crossbar in the desired position.
- Hang the gravity bins onto the metal holder.
- As a final step, fix the screws that lock the holder onto the crossbar.

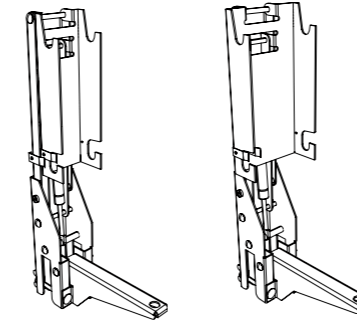

SDA4e100

SDA4e150

Installing swing down arms is the preferred option for upper levels.



4eBin™ works with the existing SDA swing down arm. For best performance it is recommended to use SDA4e swing down arm.

ON SHELF WITH FOOT:

- Fix the profile onto the shelf at the right depth (put 1 foot at each shelf end as help).
- Mount the bin to its foot.
- Angle bin slightly when inserting it into the profile. Push it into the desired position.
- Foot in combination with the profile locks the bin in place.

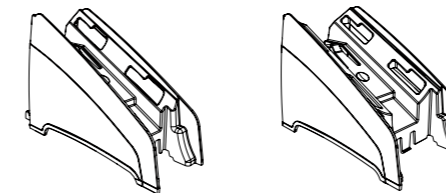

GB FOOT 100

GB FOOT 150

Model of bins	Installation support
GB4e100	1, 3, 5
GB4e150	2, 4, 6

4eBin uses the same foot as 3eBin.



BBR



Remerchandising

FIRST IN, FIRST OUT

- The unique angled floor of our gravity bins ensures automatic stock rotation. This safeguards product freshness and quality.
- Remerchandising is done through the top lid. The lid can be fully removed or just opened.
- Remerchandising for gravity bins is greatly facilitated by the use of swing down arms.
- Another option for remerchandising is to remove the bin from the racking and use the refilling trolley.



Using swing down arms facilitates remerchandising for gravity bins - especially on high fixtures which are harder to reach.

Flow control

DETERMINE THE FLOW OF MERCHANDISE

- The opening of the shutter can be set in three (3) different positions, minimum, medium and maximum flow.
- Adjust the flow by moving the Shutter Stop Pin to the desired position.
- Default setting is the minimum flow.



SHUTTER STOP PIN



Bin assembly

TIME SAVING WHEN ASSEMBLING THE FRONT COVER AND THE HANDLE

- Innovative design of the handle with integrated shutter.
- Shutter stop pin can be installed without the need of any tool.
- Flow control level can be decided when doing the front assembly. Shutter stop pin has 3 possible positions.
- Rubber springs for attachment of handle with front are designed to be installed in the outer part of the front (1 to 5).

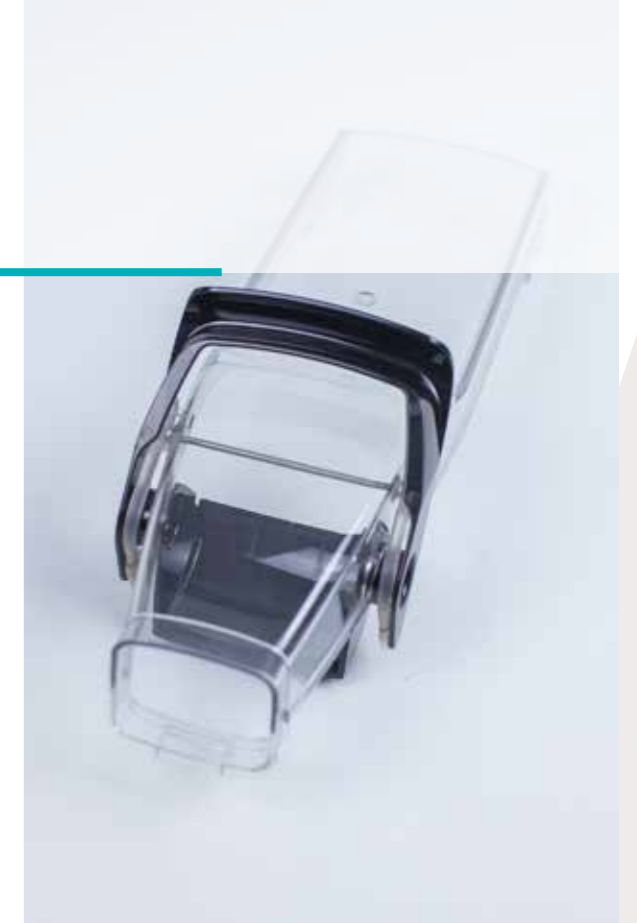

①

②

③

④

⑤

EASY AND FAST BIN BODY MOUNTING

- Disruptive new design of the bin body. The only bin in the market designed and produced in 1 part*.
- Easy to mount
- Easy to clean
- Quick release of seal for easy cleaning.
- Collar has an intuitive fixing system in the bin body.



* Bin body in 1 part provides an easier mounting, dismantling and cleaning.



①

②

③



Bin assembly (cont.)

SIMPLE INSTALLATION OF THE FALSE FRONT

- If it is needed to have a full face display of product, even at low stock level, it is recommended to install the false front. (1 to 4)
- To empty stock in false front window, open the door at the bottom of the false front.



The false front can be installed without removing the bin from the shelf.

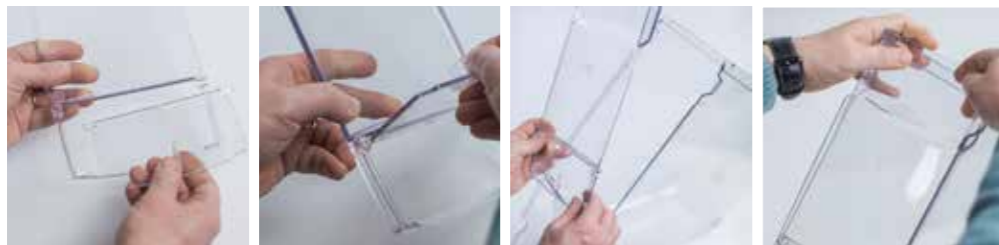

① ② ③ ④

FINAL ASSEMBLY. THE BIN IS READY TO BE USED IN ONLY 4 STEPS:

- Fix the bottom hole in the nozzle of the front cover onto the bottom hook of the body (1).
- Snap the two connectors on the bin front onto the bin body, you should hear a click when they are securely fastened (2).
- Put the lid on the top of the gravity bin (3).
- Optional: fix the sleeve around the base of the nozzle (4).



Final assembly – done in a few seconds



① ② ③ ④

Cleaning

MAINTAIN FRESHNESS AND ATTRACTIVE PRESENTATION

- Our gravity bins are completely sealed and dust proof.
- With the easy cleaning option you do not need to remove the bin from the shelf – just leave the bin body installed and take out the mounted front.
- We recommend you clean your bins regularly.

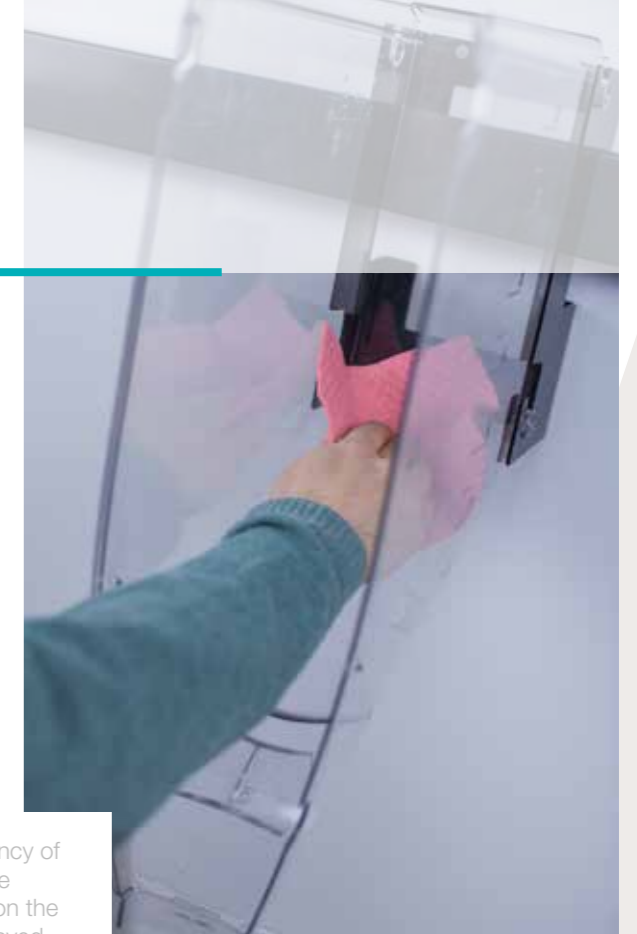

The recommended frequency of cleaning will depend on the stock rotation speed and on the type of merchandise displayed. For instance, fat or oily products require more frequent cleaning.

4ebin™ is the only bin in the market with easy cleaning



EASY-CLEAN



With the **easy-clean option**, no need to remove the bin from the shelf – just remove the front and clean the bin body in place.



TOTAL CLEANING

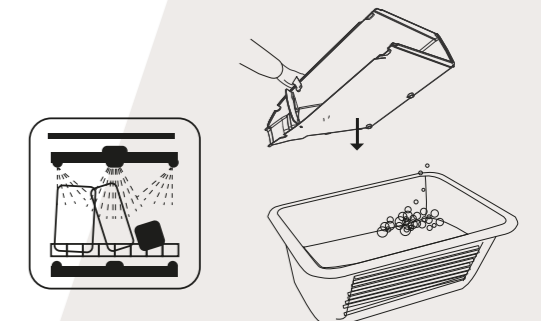

For more thorough cleaning – place all components (except for the shutter stop pin) **in the dishwasher** and wash on normal program (maximum 50°).

SOME CUSTOMERS PREFER NOT TO DO THE CLEANING THEMSELVES - YOUR HL DISPLAY REPRESENTATIVE CAN HELP YOU SOURCE A CLEANING SERVICE FOR YOUR BULK BINS.



4eBin™ - The ecological, economical, ergonomic & easy-clean bulk bin system

Ecological - A more “eco-friendly” way of shopping. Less resources are used in both transport and packaging.

Economical - Let's shoppers buy their desired quantity, and favourite mix.

Ergonomic - A delight to handle for shoppers and store personnel alike.

Easy-clean - Our revolutionary design allows for cleaning the bins without removing them from the shelf.



© HL Display - CORP0418AB28 - Edition 1/2018

Sydney

31 Severn St. St Marys, NSW, 2760

☎ +61 2 9833 0290

Roar Equipment Pty Ltd.
Shopfitting Specialists 

Perth

43 Ladner St O'Conner WA 6163

☎ 1300 054 016

